

McMinn County Economic Development Authority

P.O. Box 767 • Athens, TN 37371-0767
 (423) 745-1506 • Fax (423) 745-1507 • www.mcminncoeda.org

North Etowah Industrial Park

Etowah, Tennessee

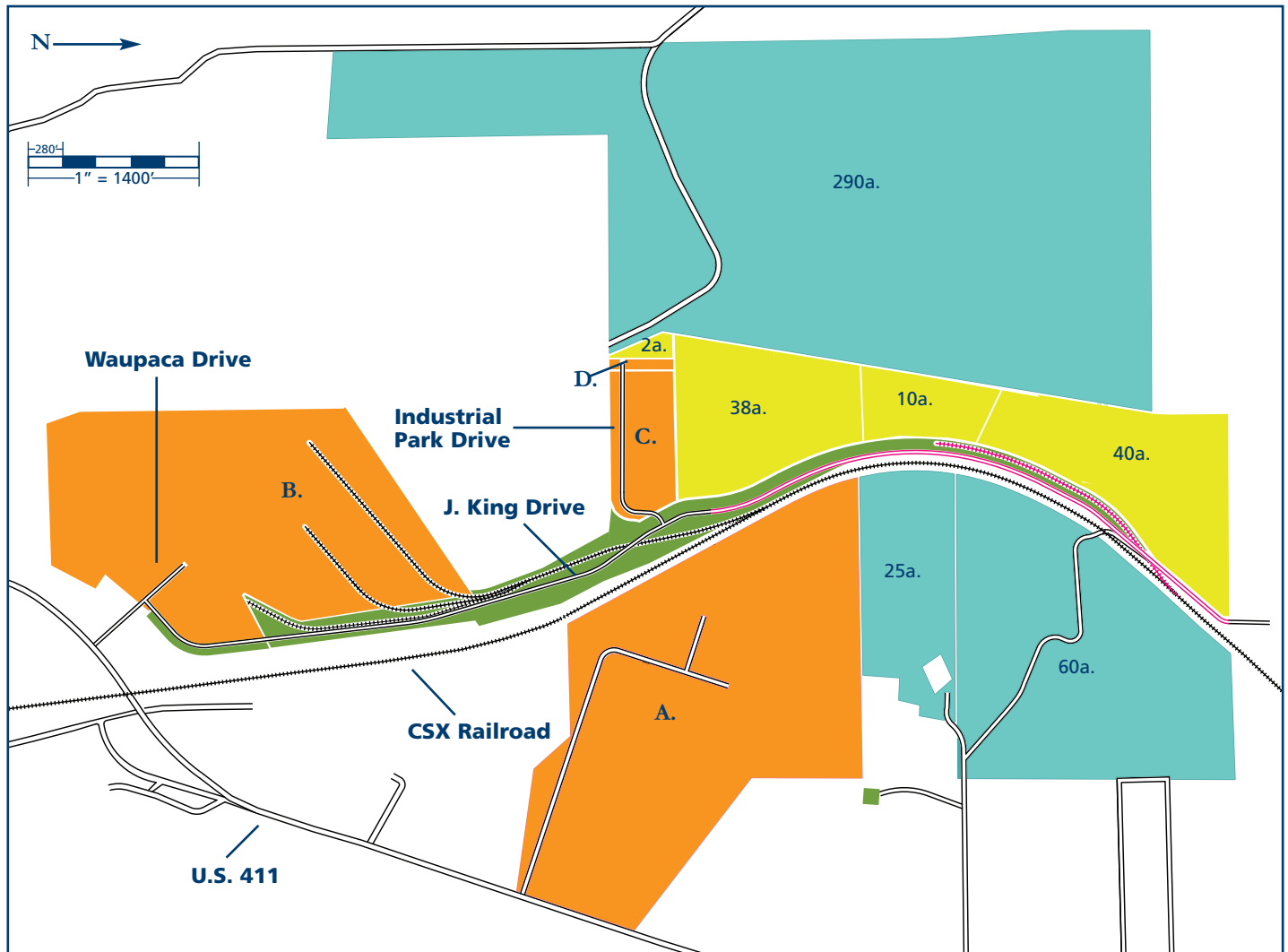

Owner: McMinn County Economic Development Authority

Inside City: Yes

County: McMinn

Acres: 600+

Remaining Available: 90 + 375

Zoned: Industrial

Nearest Highway: U.S. 411 (Adjacent)

Nearest Interstate: I-75 (12 miles)

Rail: CSX Transportation (Adjacent)

Local Airport: McMinn County (7 miles)

Commercial Airport: Knoxville (45 miles)
 Chattanooga (60 miles)

See reverse for aerial photograph

Electric: Etowah Utilities Board: 161 KV Line, 69 KV Line, 13 KV Line

Natural Gas: Etowah Utilities Board 8" Line

Water: Etowah Utilities Board 16" Line

Waste Water: Etowah Utilities Board 8" Line

Core Drilling: No

Topography Map: Yes (10' contour intervals)

Cost Per Acre: \$10,000.00

Codes/Covenants: U.S. Building Code

KEY

- McMinn County Economic Development Authority
- Private Ownership – Future Development
- Companies in Park
 - A. Johns Manville
 - B. ThyssenKrupp/Waupaca
 - C. Con/Met
 - D. InspecTech
- Open Spaces/Utilities
- Existing road
- Proposed road
- Existing railroad
- Proposed railroad